



multi-pro Tile Backer Board

WHY CHOOSE MULTI-PRO TILE BACKER BOARD?

Multi-pro Tile Backer is the stronger, faster, safer building board for wall and floor tiling, developed by Resistant Building Products. Multi-pro Tile Backer Board is mould resistant, water resistant and extremely strong.



STRONGER TILE BACKER

Proven to be extremely strong when fitted correctly and is suitable for hanging a combined weight of tile/adhesive of 100kg/m².*



ENVIRONMENTALLY FRIENDLY

Resistant boards are environmentally friendly as they produce less CO₂ emissions due to a greener cold fusion manufacturing process.



MOISTURE/WATER RESISTANT

Multi-pro Tile Backer is an ideal tile backer as it will not deteriorate, swell or rot when used in a humid environment.



SAFER TILE BACKER

Some rival tile backers contain up to 50% crystalline silica, while Multi-pro Tile Backer contains less than 0.5%, making it one of the safest boards on the market today.

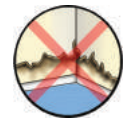

MOULD RESISTANT

Unlike paper faced or wood-based products, Multi-pro Tile Backer contains no cellulose and is resilient to mould growth.



EFFICIENT CUTTING METHOD

Can be easily scored and snapped with a standard blade or cut to shape using a small hand saw.



EASY FIXING METHOD

Boards can be simply screw fixed without pre-drilling. Fitting instructions can be found at www.resistant.co.uk.



BENEFIT YOUR PROJECT!



Multi-pro Tile Backer is Resistant's premium tile backer board. It is a cost effective solution for any project which requires high performance in a humid or moist environment. Resistant offer a 25 year guarantee with the Multi-pro Tile Backer board where it will not rot, crack or delaminate over this period of time. To find out more, visit our website or contact a member of the sales team. Contact information on reverse.

TESTING & CERTIFICATION

 First BBA certified MgO board with extensive testing carried out by the accrediting body

 Manufactured to EN 13501-1:2007 + A1:2009 for fire resistance and passed as A1 non-combustible

 *Shear tile test carried out in accordance with BS EN 1324:2007 & BS EN 1990:2002



USE OF MULTI-PRO TILE BACKER IN A HOME BATHROOM

The following diagram depicts an example layout of a bathroom fitted with Multi-pro Tile Backer board. For fully detailed fitting instructions and further information, please visit www.resistant.co.uk.

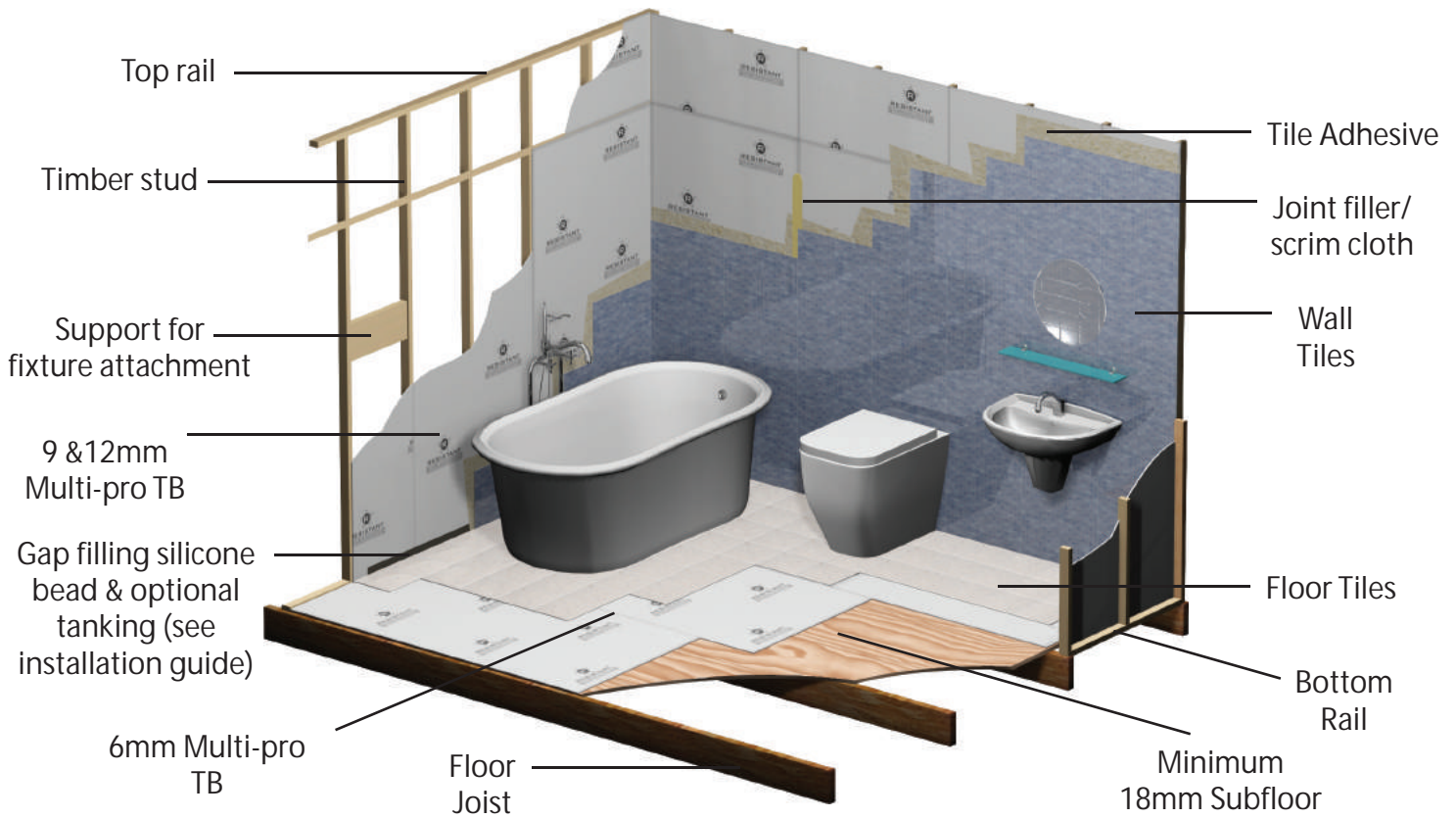

MULTI-PRO TILE BACKER VS. INDUSTRY STANDARD

Gypsum and Plywood products are frequently used as tiling substrate in showers and bathrooms where stud walls are common. Both these substrates are susceptible to deterioration if moisture penetrates through a crack or joint on a tiled wall or floor. When Multi-pro Tile Backer is used and installed as per the recommended guidelines, these problems should not occur.

<i>Metal Stud</i>		<i>Available Board Sizes</i>	<i>Weight Per Board</i>
Case hardened stainless steel Screw		800 x 1200 x 6mm	6kg
Self tapping, countersunk head		1200 x 1220 x 6mm	9.2kg
		1200 x 2400 x 6mm	18kg
		800 x 1200 x 9mm	9kg
		1200 x 2400 x 9mm	27kg
		800 x 1200 x 12mm	12kg
		1200 x 2400 x 12mm	36kg

